



Scene+ Micro Projector

User's Guide for Model PJ913B v3076-01

For the most up-to-date version of this User's Guide, go to www.gpx.com

Safety Instructions & Warnings

Important Safety Instructions

- Read these Instructions.
- Keep these Instructions.
- Heed all Warnings.
- Follow all instructions.
- Do not use this apparatus near water.
- Clean only with a dry cloth.
- Do not block any ventilation openings. Install in accordance with the manufacturer's instructions.
- Do not install near any heat sources such as radiators, heat registers, stoves, or other apparatus (including amplifiers) that produce heat.
- Do not defeat the safety purpose of the polarized or grounding - type plug. A polarized plug has two blades with one wider than the other. A grounding type plug has two blades and a third grounding prong. The wide blade or the third prong are provided for your safety. When the provided plug does not fit into your outlet, consult an electrician for replacement of the obsolete outlet.
- Protect the power cord from being walked on or pinched particularly at plugs, convenience receptacles, and the point where they exit from the apparatus.
- Only use attachments/accessories specified by the manufacturer.
- Unplug this apparatus during lightning storms or when unused for long periods of time.
- Refer all servicing to qualified service personnel. Servicing is required when the apparatus has been damaged in any way, such as power-supply cord or plug is damaged, liquid has been spilled or objects have fallen into the apparatus, the apparatus has been exposed to rain or moisture, does not operate normally, or has been dropped.
- Use only with a cart, stand, tripod, bracket, or table specified by the manufacturer, or sold with the apparatus. When a cart is used, use caution when moving the cart/apparatus combination to avoid injury from tip-over.



FCC Warnings

Warning: Changes or modifications to this unit not expressly approved by the party responsible for compliance could void the user's authority to operate the equipment.

NOTE: This equipment has been tested and found to comply with the limits for a Class B digital device, pursuant to Part 15 of the FCC Rules. These limits are designed to provide reasonable protection against harmful interference in a residential installation. This equipment generates, uses, and can radiate radio frequency energy and, if not installed and used in accordance with the instructions, may cause harmful interference to radio communications. However, there is no guarantee that interference will not occur in a particular installation. If this equipment does cause harmful interference to radio or television reception, which can be determined by turning the equipment

off and on, the user is encouraged to try to correct the interference by one or more of the following measures:

- Reorient or relocate the receiving antenna.
- Increase the separation between the equipment and receiver.
- Connect the equipment into an outlet on a circuit different from that to which the receiver is connected.
- Consult the dealer or an experienced radio/TV technician for help.

Battery Warnings

- **WARNING:** Do not ingest battery, Chemical Burn Hazard.
- If the remote control supplied with this product contains a coin/button cell battery and the coin/button cell battery is swallowed, it can cause severe internal burns in just 2 hours and can lead to death.
- Keep new and used batteries away from children. If the battery compartment does not close securely, stop using the product and keep it away from children.
- If you think batteries might have been swallowed or placed inside any part of the body, seek immediate medical attention.
- **CAUTION:** Danger of explosion if battery is incorrectly replaced. Replace only with the same or equivalent type.
- **WARNING:** There is a danger of explosion if you attempt to charge standard Alkaline batteries in the unit. Only use rechargeable NiMH batteries.
- Battery shall not be exposed to excessive heat such as sunshine, fire, or the like.
- Do not mix old and new batteries.
- Completely replace all old batteries with new ones.
- Do not mix alkaline, standard (carbon-zinc), or rechargeable (ni-cad, ni-mh, etc) batteries.
- Batteries should be recycled or disposed of as per state and local guidelines.

Additional Warnings and Precautions

- Do not look directly into the projector light.
- Use in well ventilated area with ambient temperature between 41°F–104°C (5°C–40°C).
- Do not block any ventilation openings.
- To prevent risk of overheating, place the projector in an area that does not block ventilation, such as an enclosure or cabinet that might restrict airflow.
- Do not place the projector on an unstable surface, such as a loose stack of books, bed, or cushion.
- Do not cover the projector with a blanket, curtain, or similar.
- If setting up near a wall, leave at least 10 in. (25cm) between the wall and the projector's ventilation ports.
- Use a power outlet that can be easily accessed and unplugged.
- Do not block the light coming out of the lens. The light will heat the object and may cause burns, cause

it to melt or catch fire.

- When powering off the projector, allow the cooling cycle to finish before handling or disconnecting the power supply.
- Do not use the projector if it has been damaged. Damage could be (but not limited to):
 - Unit has been dropped or something has been dropped on it or into it.
 - Something is loose or rattling inside the unit.
 - Projector has been exposed to rain or liquid.
 - Power supply or power cord is damaged.
- Do not use the projector in places where flammable gases or explosives may be present.
- Do not use the projector in the following conditions:
 - Extremely hot, cold, or humid environments
 - Environments with excessive amounts of dust and dirt in the atmosphere.
 - Near appliances generating a strong electromagnetic field or heat.
 - In direct sunlight.
- If the air vents become clogged or dirty, use a vacuum or air compressor and nozzle to clean. Do not use canned air, as the gas may leave a residue inside the enclosure.
- **CAUTION: TO PREVENT ELECTRIC SHOCK, MATCH WIDE BLADE OF PLUG TO WIDE SLOT, FULLY INSERT.**
- Mains plug is used as disconnect device and it should remain readily operable during intended use. In order to disconnect the apparatus from the mains completely, the mains plug should be disconnected from the mains socket outlet completely.
- **CAUTION:** Use of controls or adjustments or performance of procedures other than those specified may result in hazardous radiation exposure.
- **WARNING:** Changes or modifications to this unit not expressly approved by the party responsible for compliance could void the user's authority to operate the equipment.
- **WARNING:** Use of this unit near fluorescent lighting may cause interference regarding use of the remote. If the unit is displaying erratic behavior move away from any fluorescent lighting, as it may be the cause.
- **WARNING:** Shock hazard - Do Not Open.
- Caution and marking information is located at the rear or bottom of the apparatus.
- **WARNING:** To reduce the risk of fire or electric shock, do not expose this apparatus to rain, moisture, dripping, or splashing.
- Objects filled with liquids, such as vases, shall not be placed on the apparatus.
- Do not place any objects, heavy or otherwise, on the projector.
- This product meets and complies with all Federal regulations.

- See projector enclosure for related safety markings.
- No user serviceable parts inside, do not attempt to open the unit or perform any repair. Doing so may cause damage or injury, and will void your warranty.
- Refer all repairs or replacement to qualified service personnel.
- Stop using the projector and unplug the power source immediately if you notice the following:
 - Smoke coming from the unit or power supply.
 - Strange odors or noises coming from the unit.
 - Liquid or foreign objects have gotten inside the unit.
 - Unit has been dropped and enclosure has been damaged.



WARNING: To reduce the risk of electric shock, do not remove cover (or back). No user-serviceable parts inside. Refer servicing to qualified

service personnel.



The exclamation point within an equilateral triangle is intended to alert the user to the presence of important operating and maintenance (servicing)

instructions in the literature accompanying the appliance.



The lightning flash with arrowhead symbol, within an equilateral triangle, is intended to alert the user to the presence of un-insulated "dangerous voltage" within the product's enclosure that may be of sufficient magnitude to constitute a risk of electric shock to persons.



This symbol indicates that this product incorporates double insulation between hazardous mains voltage and user accessible parts.



WARNING : This product can expose you to chemicals including lead, which is known to the State of California to cause cancer and birth defects or other reproductive harm. For more information go to www.P65Warnings.ca.gov. **This product meets and complies with required Federal product guidelines.**

Table of Contents

Overview

Features - 5

Includes - 5

Projector

Controls & Inputs - 6

Projector Setup

Power - 8

Use as a Power Bank - 8

Projector Placement - 8

Tripod Mount - 9

Image Adjustment - 9

Screen Mirroring

Screen Mirroring with Android (Samsung/Miracast) - 10–11

Screen Mirroring with Apple AirPlay - 12–13

Screen Mirroring Using a Shared Network Connection - 14–15

Connecting to Other Devices

HDMI to Laptop/Macbook - 16

HDMI to Phone/Tablet - 17

Streaming Sticks - 17

MicroSD & USB Storage Devices - 18

Customer Support

Contact Information - 19

Warranty - 19

International Support - 19

Overview

Features

- Supports up to 1080p
- Native Resolution: 640 x 360
- DLP display technology
- Aspect Ratio: 16:9
- Brightness: 45 ANSI lumens
- Wi-Fi screen mirroring for iOS and Android
- I/O: HDMI, USB, MicroSD card, 3.5mm Headphone Jack
- 10" to 80" viewable screen size
- Display distance: 1.3–9.8 ft. (0.4–3m)
- Supports power bank charging through USB port (5V 1A)
- Supports MP4, AVI, MOV, MKV, RM, RMVB, MPG, MPEG, ASF, 3GP, 3GPP, FLV, VOB, and DAT video files
- Built-in speaker
- Manual focus adjust

Includes

- Tripod
- HDMI cable
- AC/DC power adapter with USB-C jack
- User's Guide

Projector

Controls & Inputs

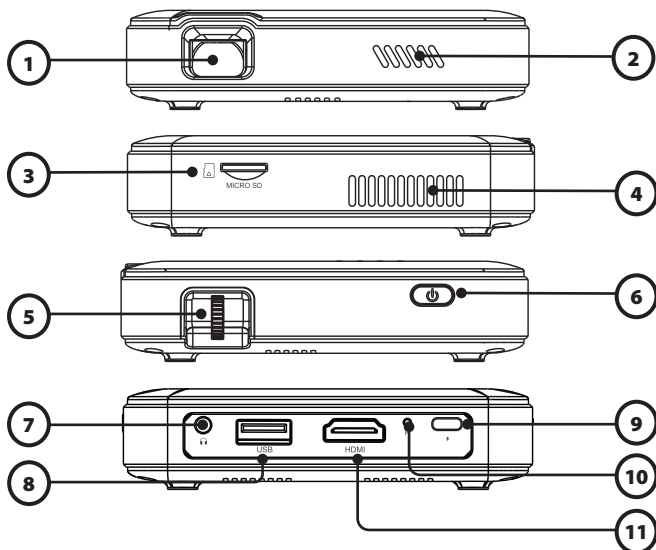

- 1. Projector Lens**
- 2. Speaker**
- 3. MicroSD Slot**
- 4. Air vent** - To prevent overheating, do not block.
- 5. Focus wheel** - Roll to fine tune the projected image.
- 6. Power button** - Press and hold for 3 seconds to power the projector ON/OFF.
- 7. Audio jack** - Connect to an external speaker or headphones.
- 8. USB port** - Video/image input and power source for HDMI streaming stick.
- 9. USB-C power input**
- 10. Reset button** - Press to reset projector in the event of screen freezing.
- 11. HDMI port**

Projector

Controls

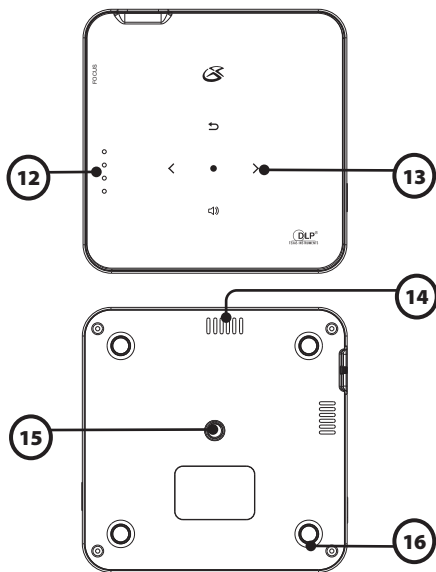

- 12. LED Power Indicator** - Indicates current power status. All LEDs will light up when unit is fully charged. LEDs will flash when battery power is low.
- 13. Touch Buttons** - Press to control projector function and volume.
- 14. Air vent** - To prevent overheating, do not block.
- 15. Tripod Mount** - Hole to attach M6 sized tripod screw.
- 16. Rubber foot pads** - Provide stability and airflow when projector is not mounted on a tripod.

Projector Setup

Power

Plug the AC/DC power adapter with USB-C jack (included) into a powered-on computer or wall outlet adapter and the USB-C power input on the rear of the unit.

To charge unit: Charging time to full power is approximately 2 hours.

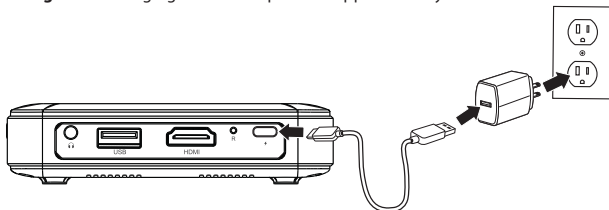

Use as a Power Bank

To charge mobile devices: Plug the unit into a wall outlet or other power source outlined in the steps above. Use an appropriate USB charging cable to connect the USB port on the projector and the device you wish to charge. Unit charges with a 5V 1A output.

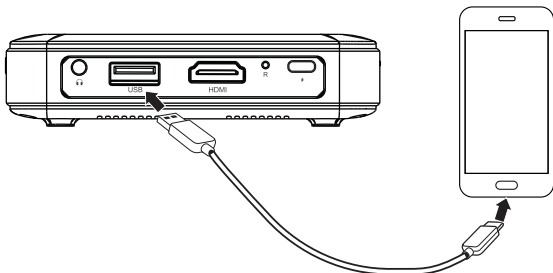

Projector Placement

For best results, place the projector in a dark room or other dimly lit area. The projector will display a screen size from 10" to 80". Adjust the projector angle and distance to best suit your needs.

Use the unit with a dedicated projector screen for best picture resolution. Projector screens are not included. If you are not using the unit with a screen, a smooth, white or lightly colored surface will provide the best results.

Projector Setup

Tripod Mount

You can use the projector by placing it on a flat surface with proper ventilation or by mounting it to a tripod. Tripod use is recommended with USB, MicroSD, and Screen Mirroring. Placing the projector on a flat surface is recommended for HDMI connections.

Attach the included tripod to the projector using the tripod mount. If you wish to use another tripod, attach it to the bottom of the projector using an M6 screw.

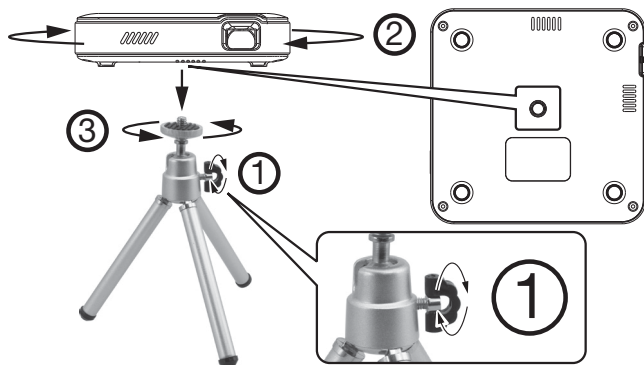
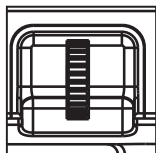
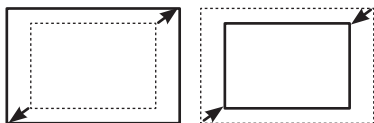

Image Adjustment



Adjust focus with focus wheel on the side of the projector.



Focus Adjustment

Increase or reduce image size to sharpen image.

Screen Mirroring

Screen Mirroring with Android (Samsung/Miracast)

This projector supports screen mirroring on Android devices using Miracast.

Note: Check that your Android device supports video out. Some streaming apps do not allow video output or screen mirroring, such as Netflix. To use these streaming services, use an HDMI streaming stick (page 13).

1. Turn on the projector. From the home menu select "Wireless" to bring up the Screen Mirroring screen using the touch buttons on the top of the projector.



Wireless

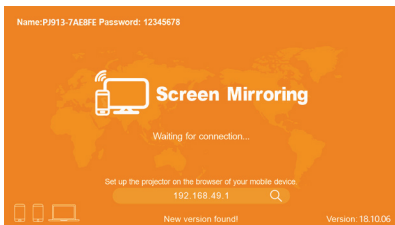

2. Open the navigation bar of your Android phone and select the Smart View function. After selecting the Smart View function, your phone will automatically search for devices.

Screen Mirroring

3. Select the projector name that appears on the upper left corner of the Screen Mirroring screen. After connecting, the projector will automatically display the images on the screen of your phone.

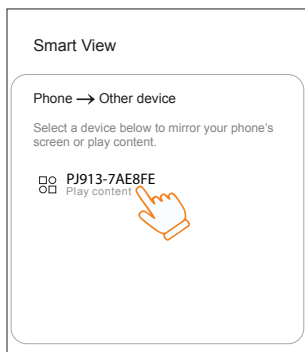
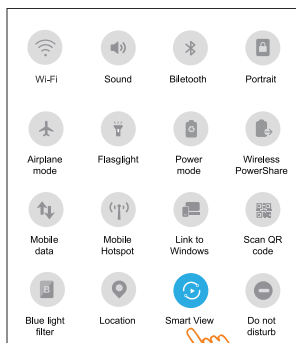

Screen Mirroring

Screen Mirroring with Apple AirPlay

This projector supports screen mirroring on iPhones using Apple AirPlay.

Note: This method involves connecting your phone to the projector using a Wi-Fi connection. After connecting, your phone will automatically switch over to a network-based data connection.

1. Turn on the projector. From the home menu select "Wireless" to bring up the Screen Mirroring screen. using the touch buttons on the top of the projector.



Wireless

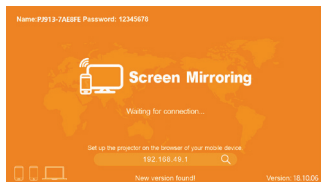

2. Go to the Wi-Fi menu on the settings menu on your phone. Search for available networks and select the name of the projector as it appears on the upper left corner of the Screen Mirroring screen.

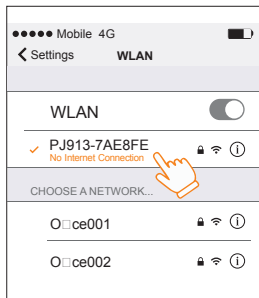

Screen Mirroring

3. When prompted, enter the password that appears next to the projector name on the upper left corner of the Screen Mirroring screen.
4. Exit the Wi-Fi menu and open the Control Center menu by swiping down from the top-right edge or using the Assistive Touch home button.

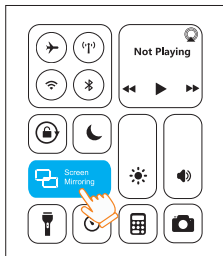

5. Select the Screen Mirroring option. The projector will automatically display the images on the screen of your phone.

Screen Mirroring

Screen Mirroring using a Shared Network

This projector supports screen mirroring on Android devices and iOS devices through a shared network connection.

Note: Check that the app you intend to stream from supports screen casting.

1. Turn on the projector. From the home menu select "Wireless" to bring up the Screen Mirroring screen using the touch buttons on the top of the projector.



Wireless

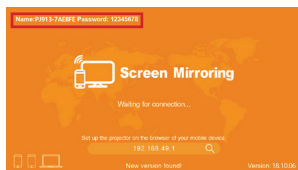

2. Using the network settings on your mobile device, connect to the projector using the network name and password in the upper left corner.
3. Open the browser on your mobile device and enter the IP address on the wireless screen in the browser search bar. Tap the "WiFi AP" icon on the resulting screen.

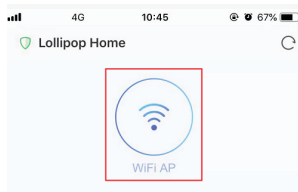
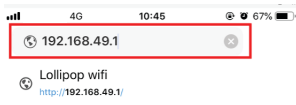

Screen Mirroring

4. Scan for available networks and select your desired Wi-Fi network from the list. Then, enter your network password to connect.
5. The wireless screen on the projector will now show a router connection in the upper right corner. Your mobile device will also show a wireless connection instead of a data connection. You can now screen mirror using the network connection.

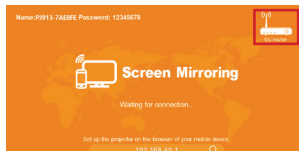
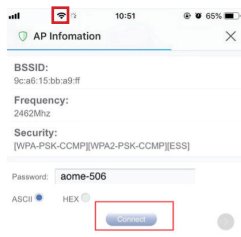

To disconnect from the network:

1. Enter the IP address on the wireless screen into your internet browser. Tap the Wi-Fi icon to see saved access points.
2. Tap "Forget" next to the network you want to remove from the projector. The projector will be disconnected from that network and the router symbol on the wireless screen will disappear.

Connecting to Other Devices

HDMI to Laptop/Macbook

HDMI offers superior sound and picture quality and is the easiest way to play media from a computer.

- 1. For a PC laptop:** Connect the device directly using the included HDMI cable
- 2. For a Macbook:** If your Macbook version does not have an HDMI port, you will need a USB-C digital AV multiport adapter (not included). Connect one end of the HDMI cable to the projector and the other end to the adapter. Then, plug the adapter into your Macbook.

Laptop

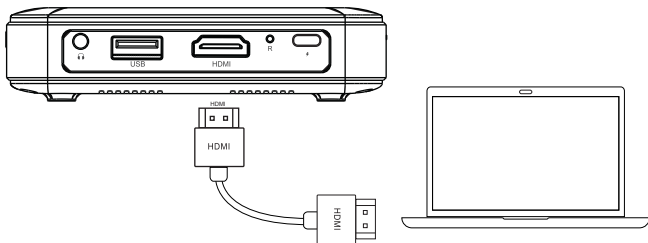

Macbook

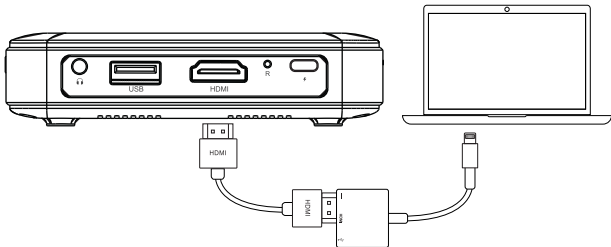

Connecting to Other Devices

HDMI to Phone/Tablet

Requires an HDMI cable (included) and an HDMI adapter suited for your device (not included).

1. **Android devices:** Connect the HDMI cable to the projector. Then, connect the other end of the HDMI cable to a USB-C to HDMI adapter. Connect the adapter to your device.
2. **For iPhones and iPads:** Connect the HDMI cable to the projector. Then, connect the other end of the HDMI cable to an Apple Digital AV Adapter. Connect the adapter to your device.

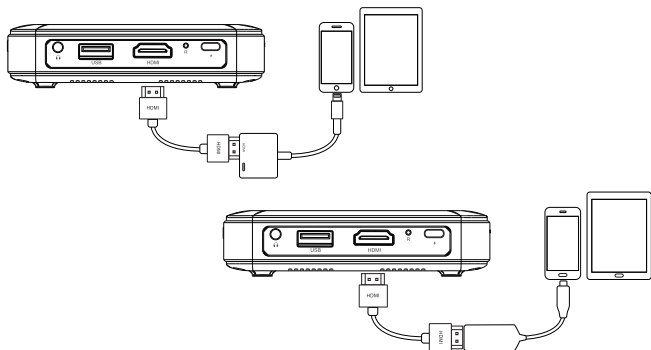

Streaming Stick

Supports Fire TV Stick, Roku, and Chromecast. The projector can provide power to some streaming sticks using the USB drive (5V/1A power).

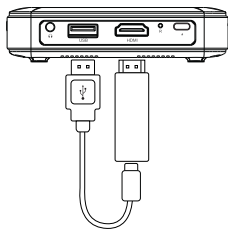

Connecting to Other Devices

MicroSD & USB Storage Devices

Supports MicroSD cards and USB drives up to 1TB. Supports file formats:

- Image: JPEG, PNG, BMP, MPO
- Video: MP4, AVI, MOV, MKV, RM, RMVB, MPG, MPEG, ASF, 3GP, 3GPP, FLV, VOB, DAT
- Audio: 3GP, WAV, MP3, AAC, RM, FLAC, OGG

To play media:

1. Insert a MicroSD card or USB drive into the projector.

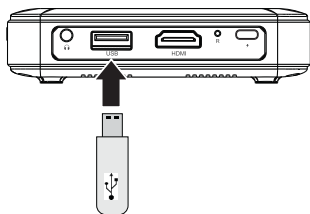
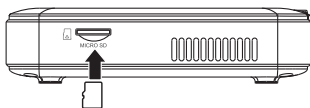

2. From the home screen, select which media you would like to play using the touch buttons on the top of the projector. (Photo or Video).
3. After selecting the media type, files on your external storage device will appear on screen. Select which media you would like to play using the touch buttons on the top of the projector.

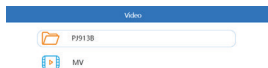

Customer Support

Contact Information

Website: www.gpx.com

Email Support: prodinfo@dpiinc.com

Email Parts: partsinfo@dpiinc.com

Phone Support: 1-888-999-4215



*Protect for Today
Sustain for Tomorrow*

Warranty

For Warranty Information and the most up-to-date version of this User's Guide, go to: www.gpx.com

International Support

To download this User's Guide in English, Spanish, and French, or to get answers to frequently asked questions, visit the support section at: www.gpx.com

Para descargar este Manual del Usuario en inglés, español y francés, o para obtener respuestas a preguntas frecuentes, visite la sección de apoyo en: www.gpx.com

Pour télécharger ce guide de l'utilisateur en anglais, espagnol ou français, ou pour obtenir des réponses à des questions fréquemment posées, consultez la rubrique d'assistance sur: www.gpx.com

Copyright © 2023 Digital Products International (DPI, Inc.) All other trademarks appearing herein are the property of their respective owners. Specifications are subject to change without notice.

