

Introduction

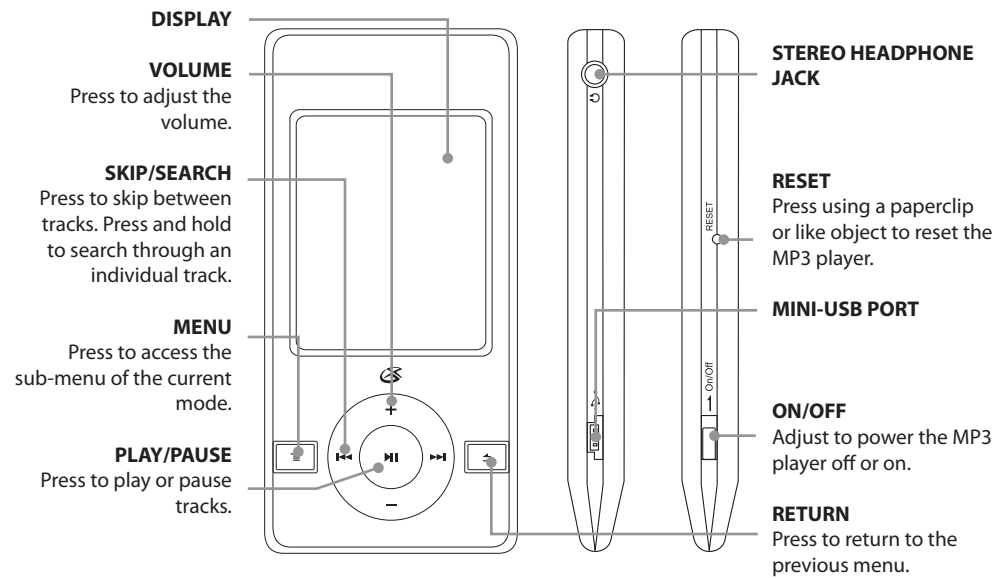

Charging

- 1 Connect the digital media player to a computer to charge its internal battery.
- 2 Make sure your computer is connected to an AC outlet and turned on (not in sleep mode).

Loading Files

- 1 Connect the unit to a computer (Windows or Apple) using the **MINI-USB** connection and the included USB cable.
- 2 Once connected, the unit will show up on the connected computer as if it were a connected USB thumb drive, external hard drive, or memory card.
- 3 Drag and drop the desired audio, video, or photo files into the unit's drive location on the connected computer.

File Compatibility:

MUSIC: MP3, WMA

VIDEO: AMV

VOICE: WAV

PHOTOS: JPEG, BMP

- 4 After the files are loaded onto the unit, right-click on the drive and eject it from the computer, then disconnect the USB cable.

Music

- 1 Power the digital media player on.
- 2 Navigate to the Music icon on the main menu and press the **PLAY** button.
- 3 Press the **PLAY** button to begin playing music from your digital media player.

Play Options

While in Music mode, press the **MENU** button to access the Music sub-menu.

Repeat

- Normal
- Repeat one
- Folder
- Repeat Folder
- Repeat all
- Random

Equalizer

- Natural
- Rock
- Pop
- Classic
- Jazz
- DBB

Photo

- 1 Power the digital media player on.
- 2 Navigate to the Photo icon on the main menu and press the **PLAY** button.
- 3 Navigate through the file browser using the **VOLUME** buttons, and press the **PLAY** button to select a JPEG or BMP photo file.
- 4 Press the **RETURN** button to return to the Main Menu.

Record

- 1 Power the digital media player on.
- 2 Navigate to the Record icon on the main menu and press the **PLAY** button.
- 3 The digital media player will begin recording automatically.
- 4 Press the **PLAY/PAUSE** button to stop or resume recording.
- 5 Press the **RETURN** button to save.
- 6 Press the **RETURN** button again to return to the Main Menu.

Voice

- 1 Power the digital media player on.
- 2 Navigate to the Voice icon on the main menu and press the **PLAY** button.
- 3 Press the **SKIP/SEARCH** buttons to cycle through the available recordings.
- 4 Press the **PLAY** button to begin playing the selected recording.
- 5 Press the **RETURN** button to return to the Main Menu.

Video

File-type Requirements: AMV

Use the included Video Conversion Software to convert video files to the AMV format so that they can play on the digital media player.

- 1 Power the digital media player on.
- 2 Navigate to the Video icon on the main menu and press the **PLAY** button.
- 3 Navigate through the file browser using the **VOLUME** buttons, and press the **PLAY** button to select a video file.
- 4 Press the **RETURN** button to return to the Main Menu.

Using the Video Conversion Software

System Requirements: Windows 2000, Win 7, ME, or XP

1. Connect the media player to a computer using the included USB cable.
2. Once connected, the video conversion software will open automatically.
3. Use the conversion software to select a video on your computer and convert it to the AMV format so it will be playable on the media player.
4. After converting, follow the instructions for Loading Files to load the newly created AMI file to the media player.

This video conversion software may be blocked by some anti-virus applications. If you are experiencing issues when attempting to run this program, please disable your anti-virus software or try using another computer. Re-enable your anti-virus software immediately after you finish using the video conversion software.

Please note, disabling your anti-virus software exposes your computer to potential threats. Disable at your own risk.

If the PC is running Windows 7, please select the desired location of the file (other than the C drive) after it has been converted in the OUTPUT FILE field of the program.

For more information on this subject, please visit

www.gpx.com and select the support tab and then FAQ.

Setup

- LCD Set
- Language
- Power Off
- Reset
- Firmware version
- Memory Info

FCC Warnings

WARNING: Changes or modifications to this unit not expressly approved by the party responsible for compliance could void the user's authority to operate the equipment.

NOTE: This equipment has been tested and found to comply with the limits for a Class B digital device, pursuant to Part 15 of the FCC Rules. These limits are designed to provide reasonable protection against harmful interference in a residential installation. This equipment generates, uses, and can radiate radio frequency energy and, if not installed and used in accordance with the instructions, may cause harmful interference to radio communications. However, there is no guarantee that interference will not occur in a particular installation. If this equipment does cause harmful interference to radio or television reception, which can be determined by turning the equipment off and on, the user is encouraged to try to correct the interference by one or more of the following measures:

- Reorient or relocate the receiving antenna.
- Increase the separation between the equipment and receiver.
- Connect the equipment into an outlet on a circuit different from that to which the receiver is connected.
- Consult the dealer or an experienced radio/TV technician for help.
- **CAUTION:** Danger of explosion if battery is incorrectly replaced. Replace only with the same or equivalent type.
- **PRÉCAUTION:** Danger d'explosion si les piles sont remplacées de façon incorrect. Remplacer les piles seulement par le même type de pile ou l'équivalent.
- **WARNING:** The battery, batteries, and battery pack shall not be exposed to excessive heat such as sunshine, fire, or the like.

GREEN INITIATIVE

Environmental Commitment to 'Protect for Today and Sustain for Tomorrow'

2009 marks the official launch of DPI, Inc.'s corporate campaign for a greener and cleaner world. DPI and its four brands, iLive, WeatherX, Capri, and GPX, are building upon environmental initiatives introduced at all of their facilities to help formulate and sustain significant and important conservation efforts within its manufacturing and marketing communities. In addition to targeting and selecting energy efficient product features, and structuring 'green office' procedures, other initial program efforts include:

Reduction of all packaging sizes

Recyclable plastics for clamshell packages, with a plan to eventually replace plastic with recyclable paper

Recycled fiber board in place of the polyfoam in packing boxes

Recycled plastics in place of the virgin material in product construction

INTERNATIONAL SUPPORT

To download this User's Guide in English, Spanish, or French, visit the support section at www.gpx.com.

Para transferir esta guía de usuario en inglés, español, o francés, visite la sección de la ayuda en www.gpx.com.

Pour télécharger ce guide de l'utilisateur en anglais, espagnol, ou français, visitez la section de soutien chez www.gpx.com.

SERVICE INFORMATION

Phone: 1-888-999-4215

Email: prodinfo@gpx.com

Parts Email: partsinfo@dpi-global.com

Website: www.gpx.com